



# FLOOD WALL PANELS

Flood manufacture solid precast concrete wall systems in 150mm and 200mm thick. The Flood Wall solid panel extends the Flood Flooring philosophy of mass-producing a product on a long line system.

## 200mm solid Wall

Mainly used in residential developments to form the party walls and load bearing walls. Window and door opes can easily be formed in the panels which allow the panel to be used as elevation walls

The "Flood 200" panel is produced in standard widths of 2.4m. Due to the modular concept of the wall system, it can be mass-produced on steel moulds. This results in a high quality surface to the panels. Therefore a decorative finish such as Alltek can be applied to the walls, eliminating the need to slab and skim walls. Units are stored on flat and transported on standard flat-bodied trailers and erected on site with a tower or mobile crane.

All of the above contribute to our commitment to meet the construction programme of the project and provide a very cost effective system when compared with other methods of construction.

The average mass of the wall (including the plasterboard) should be at least 415 kg/m<sup>2</sup>. Fill joints between panels with mortar. (Extract from Building Regulations 1997 Technical Guidance Document for Sound, Par. 2.1 D.)

Flood Wall Panel = 480 kg/m<sup>2</sup>.

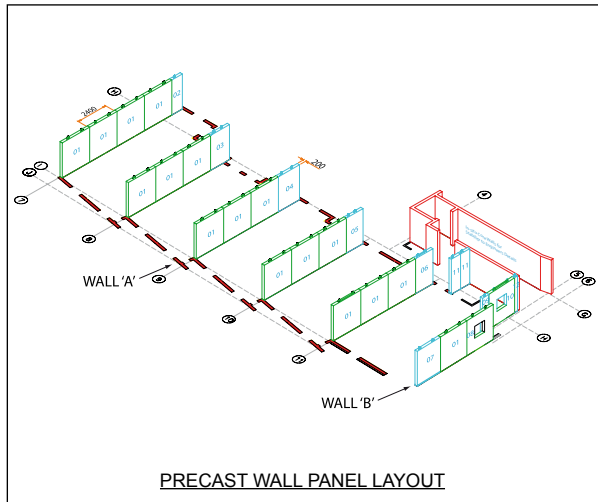

PRECAST WALL PANEL LAYOUT

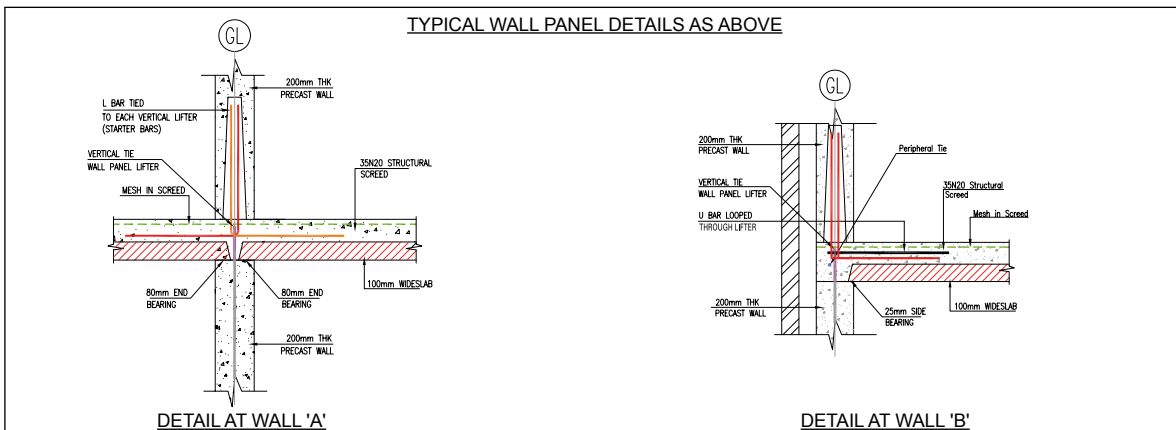

TYPICAL WALL PANEL DETAILS AS ABOVE

DETAIL AT WALL 'A'

DETAIL AT WALL 'B'

**150mm Solid wall**

Mainly used in industrial units to form the party walls as part of the steel frame structure.

The "Flood 150" solid panel is manufactured in heights of 2.4m. The profile of the panel is designed to allow each panel to interlock with another. This allows for stacking the panels on top of each other to provide the party walls. The panels are permanently fixed in place by an angle detail bolted to the steel columns.

**General**

Flood Flooring has an experienced in house design team. Therefore we can design, manufacture and deliver the complete structure to our clients.

All panels are designed in accordance with BS 8110 and current building regulations governing sound and fire proofing properties.

**Advantages of using Flood wall system.**

- Reduction in construction programme.
- Reduction in site supervision and scaffolding.
- Design and manufacture result in short lead in time to delivery.
- Units are stored on flat reducing site storage areas and expensive storage frames.
- Units are transported on standard trailers.
- Panels are formed on steel beds providing a high quality surface.
- Conduit and socket boxes can be cast into the units.
- No on site pouring of concrete like the twin wall system.
- All dowels and joints are filled with a non-shrink grout.
- Factory produced system resulting in reduced site down time.



Walls erected in an industrial unit

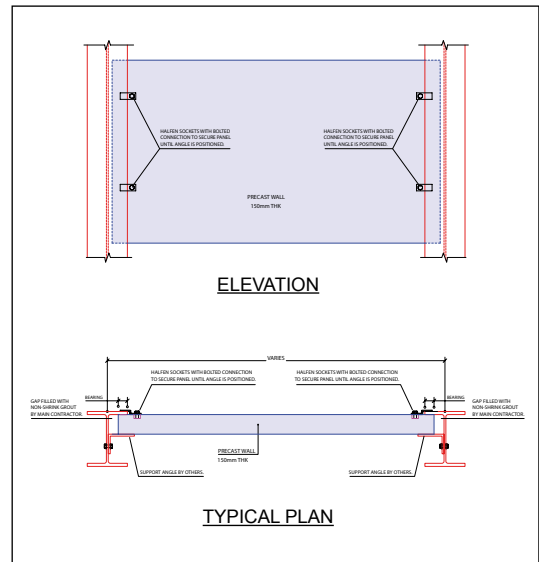

The specifications contained in this brochure are for information purposes only. Our products are continually updated and changes may be made to the specification from time to time. Specifications are subject to change without notice. Issue date March '07. This brochure supersedes all undated and predated copies.

**Flood Flooring Limited**

Hilltown, Oldcastle, Co Meath, Tel: 049 - 8541477, Fax: 049 - 8541311, E-mail: info@floodflooring.com

The technical office of Flood Flooring should always be contacted in relation to technical data for each specific contract, before its commencement.