

PRELIMINARIES

The following recommendations should be read in conjunction with the assembly drawing of the floor.

Contractor / Purchaser must report any discrepancy between drawings of the Flood Flooring design office.

Block and Plank floor is manufactured according to the design considerations of span and load as mentioned in the quotation. The quality of material to be used must comply with the Standard Specifications, Codes of Practice.

The execution of the work should be carried out under the direction of a competent supervisor.

The recommendations are limited to operations, which specifically apply to Block and Plank floors. Good working practice must also apply.

DESCRIPTION OF THE COMPONENTS OF BLOCK AND PLANK FLOORS

The concrete plank incorporating a lightweight steel girder and additional pre-stress wires are required by design conditions.

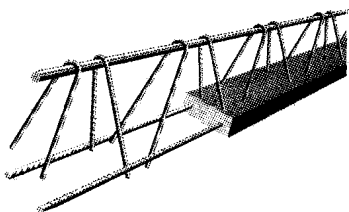

Block

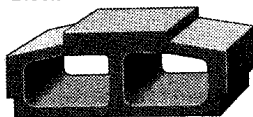

Tray Block

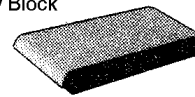

HANDLING

AND STACKING

The prefabricated units should be stacked on levelled ground, as near as possible to where required and in the proper sequence for erection. If possible, unload directly into the bay, where they are required.

The Planks should be handled, carried and stacked with the lattice upright. Two boards should be inserted between layers, vertically above each other. First layer should be stacked on bearers. Crane lifting gear should be applied to upper boom of girder at approx. 1/5 of its length from either end.

Planks can be hoisted in batches of up to 6 planks by using a proper Lifter of adequate capacity. The bar has to be passed under the upper boom of the girder. The Hollow-Blocks should be stacked with the cavity running vertically, the Tray Blocks likewise and closely joined.

ERECTION OF COMPONENTS

The Contractor / Purchaser should be aware of its responsibility to provide adequate edge protection and fall arrest systems.

It is most essential, that the right types of planks and blocks are placed in the positions shown on the drawings.

Make sure, that the blocks and planks delivered to site are of corresponding size noted on the drawing or schedule and report discrepancies to Flood Flooring Ltd.

The planks shall be always erected on supporting structure and laid accurately at the centres shown in the drawings. Practised operatives have found it convenient to use In-filler elements as gauge on either end of plank to make sure, that planks are placed so, that the filler units will fit easily.

Gauge boards can be used too, but it is important to keep a constant check on the overall running dimensions. Irregularities, which might prevent the blocks from seating properly have to be removed before the blocks are laid.

Before placing the infiller elements, planks should be supported by props and bearers at the positions shown on the drawings.

The blocks are laid from above between the planks. Check blocks for cracks and reject if suspect.

Make sure, that the different types of elements are positioned in accordance with the drawings. No holes or other cavities shall be left in any concrete work unless approved by Flood Flooring Ltd.

PROPPING AND CAMBERS

Props and bearers or effective equivalent to prevent deformation under the weight of insitu concrete, construction loads and other forces must temporarily support the Concrete Planks. The centres of the temporary supports will be shown on the drawing. Centres will be shown on drawings by a triple line marked PROP LINE.

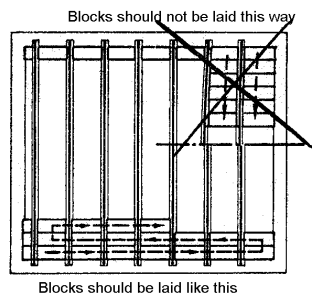

It is noteworthy, that a flat soffit can be obtained only by propping the planks during erection to a suitable camber, which counteracts the effect of deflection under loads. It is suggested, that the upward camber at midspan shall be 3 mm per running metre of span, thus:

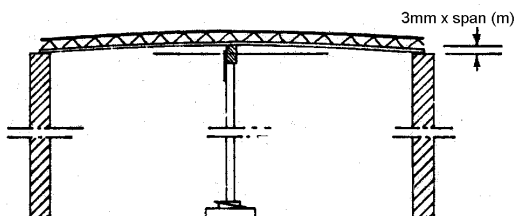

camber (in millimetres) = 3 X width of span (in metres)

This is a "rule-of-thumb" suggestion, however, and for accurate instructions based on deflection calculations, Flood Flooring should be asked.

A spirit or optical level should be used to set the floor to the above mentioned camber.

Camber should not be measured from the floor below. Where Planks are parallel with and connected to in situ concrete beams, walls or other stiff structural elements, the cambers of adjacent planks shall be adjusted as follows:

Plank adjacent to the stiff structural element = Camber as structural element

Plank adjacent to last = 1/3 of full camber

Plank next to previous = 2/3 of full camber

All other planks = full camber

PLACING OF IN SITU CONCRETE

The quality of concrete to be used and the thickness of structural topping, where applicable, will be laid down on the drawing.

In placing concrete topping great care must be taken to ensure, that the full depth of structural topping is maintained. It is particularly important, that allowance is made for the pre-set camber of the floor, to ensure, that reduction in thickness of structural concrete topping does not occur at the centre of the span.

Make sure, that temporary supports are firmly fixed and cambers maintained.

Wet the surfaces of blocks and planks exposed to in situ concrete. Blocks should be checked for cracks or breaks and if necessary replaced.

Prepare in situ concrete of quality as specified in the drawing.

Lay concrete in the ribs between the blocks and consolidate. Where structural topping is required, it should be cast simultaneously with the ribs. Ensure, that consolidation around the girder is thoroughly effected.

During erection and concreting, loads are limited to 150 kg/m². For barrow runs, foot traffic etc. duckboards should be provided.

If concrete is being lifted by means of crane and skip, make sure, that the discharge is distributed to avoid concentrated loads particularly between supporting centres.

The strength of the concrete shall be not less than that laid down in the drawings and shall be ascertained by tests as required by the specification.

STRIKING TIME OF TEMPORARY PROPPING

The temporary supports should be left in position until the concrete has matured sufficiently to take the stresses due to load conditions. The time required depends on the quality of concrete used, on curing conditions, etc.

If propping is to take place from the lower floors, it is essential, that these floors in turn are supported to prevent deformations and damages.

It is the Contractor's / Purchasers responsibility to make sure, that the removal of the temporary supports is adjusted to a point of time, so that the structure is not overloaded, distorted or damaged in any way.